

ELECTRICAL PRODUCTS CATALOG

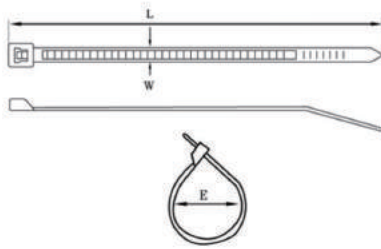

Nylon Cable Tie



CAT#	Trade Size	L		W mm	E mm	Tensile Strength	
		Inch	mm			LBS	KGS
T25060	2.5x60	2.4"	60	2.5	2-11	18	8
T25080	2.5x80	3.2"	80		2-16		
T25100	2.5x100	4.0"	100		2-22		
T25120	2.5x120	4.7"	120		2-30		
T25150	2.5x150	6.0"	150		2-35		
T25160	2.5x160	6.3"	160		2-40		
T25200	2.5x200	8.0"	200		2-50		
T36140	3.6x140	5.5"	140		3.6		
T36150	3.6x150	6.0"	150	3-35			
T36180	3.6x180	7.1"	180	3-42			
T36200	3.6x200	8.0"	200	3-50			
T36250	3.6x250	10"	250	3-65			
T36280	3.6x280	11"	280	3-70			
T36300	3.6x300	12"	300	3-80			
T36370	3.6x370	14.6"	370	3-105			
T36400	3.6x400	16"	400	3-105			
T48100	4.8x100	4"	100	4.8		3-22	50
T48120	4.8x120	4.7"	120		3-30		
T48160	4.8x160	6.3"	160		3-40		
T48180	4.8x180	7.1"	180		3-42		
T48190	4.8x190	7.5"	190		3-46		
T48200	4.8x200	8.0"	200		3-50		
T48250	4.8x250	10"	250		3-65		
T48280	4.8x280	11"	280		3-70		
T48300	4.8x300	12"	300		3-80		
T48350	4.8x350	14"	350		3-90		
T48360	4.8x360	14.2"	360		3-94		
T48370	4.8x370	14.6"	370		3-98		
T48380	4.8x380	15"	380		3-102		
T48400	4.8x400	16"	400		3-105		
T48430	4.8x430	16.9"	430		3-120		
T48450	4.8x450	17.7"	450		3-130		
T48500	4.8x500	19.7"	500		3-150		
T48550	4.8x550	21.6"	550		3-162		
T48920	4.8x920	36.2"	920	3-265			

CAT#	Trade Size	L		W mm	E mm	Tensile Strength				
		Inch	mm			LBS	KGS			
T72150	7.2x150	6.0"	150	7.2	3-35	120	55			
T72200	7.2x200	8.0"	200		3-50					
T72250	7.2x250	10"	250		4-65					
T72280	7.2x280	11"	280		4-78					
T72300	7.2x300	12"	300		4-80					
T72350	7.2x350	14"	350		4-90					
T72370	7.2x370	14.6"	370		4-98					
T72380	7.2x380	15"	380		4-100					
T72400	7.2x400	16"	400		4-105					
T72450	7.2x450	18"	450		4-110					
T72500	7.2x500	20"	500		4-150					
T72550	7.2x550	21.6"	550		4-165					
T721000	7.2x1000	40"	1000		4-300					
T76200	7.6x200	8.0"	200		7.6			3-50	120	55
T76250	7.6x250	10"	250	4-65						
T76280	7.6x280	11"	280	4-78						
T76300	7.6x300	12"	300	4-80						
T76370	7.6x370	14.6"	370	4-98						
T76380	7.6x380	15"	380	4-100						
T76400	7.6x400	16"	400	4-105						
T76450	7.6x450	18"	450	4-110						
T76500	7.6x500	20"	500	4-150						
T76530	7.6x530	20.9"	530	4-160						
T76550	7.6x550	21.6"	550	4-165						
T76750	7.6x750	29.5"	750	4-225						
T88278	8.8x278	11"	278	8.8		8-75	175	79.4		
T88400	8.8x400	16"	400			8-105				
T88450	8.8x450	18"	450		8-118					
T88500	8.8x500	20"	500		8-150					
T88550	8.8x550	21.6"	550		8-160					
T88600	8.8x600	23.6"	600		8-170					
T88650	8.8x650	25.6"	650		8-185					
T88720	8.8x720	28.3"	720		10-195					
T88800	8.8x800	31.5"	800		10-230					
T88900	8.8x900	35.5"	900		10-265					
T881000	8.8x1000	40"	1000		10-300					
T881100	8.8x1100	43.3"	1100		10-335					
T881200	8.8x1200	47.2"	1200		10-370					

Nylon Cable Gland

Material: PA (Nylon) UL 94

Working Temperature: -40°C to 100°C in static state, Instantaneous heat resistance up to 120°C

-20°C to 80°C in dynamic state, Instantaneous heat resistance up to 100°C

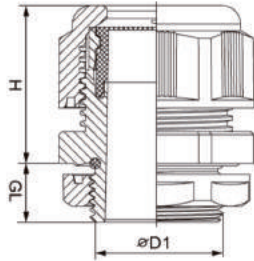

CAT#	Thread	Dimension (mm)		Cable Range mm
	φ D1	H	GL	
NGP0707	PG7	21	8	3-6.5
NGP0705	PG7	21	8	2-5
NGP0908	PG9	21	8	4-8
NGP0906	PG9	22	8	2-6
NGP1110	PG11	25	8	5-10
NGP1107	PG11	25	8	3-7
NGP13512	PG13.5	27	9	6-12
NGP13509	PG13.5	27	9	5-9
NGP1614	PG16	28	10	10-14
NGP1612	PG16	28	10	7-12
NGP2118	PG21	31	11	13-18
NGP2116	PG21	31	11	9-16
NGP2925	PG29	39	11	18-25
NGP2920	PG29	39	11	13-20
NGP3632	PG36	48	13	22-32
NGP3626	PG36	48	13	20-26
NGP4238	PG42	49	13	32-38
NGP4231	PG42	49	13	25-31
NGP4844	PG48	49	14	37-44
NGP4835	PG48	49	14	29-35

CAT#	Thread	Dimension (mm)		Cable Range mm
	φ D1	H	GL	
NGM1207	M12x1.5	21	8	3-6.5
NGM1205	M12x1.5	21	8	2-5
NGM1608	M16x1.5	22	8	4-8
NGM1606	M16x1.5	22	8	2-6
NGM1610	M16x1.5	25	8	5-10
NGM2012	M20x1.5	27	9	6-12
NGM2009	M20x1.5	27	9	5-9
NGM2014	M20x1.5	28	9	10-14
NGM2414	M24x1.5	28	12	10-14
NGM2518	M25x1.5	31	11	13-18
NGM2516	M25x1.5	31	11	9-16
NGM3225	M32x1.5	39	11	18-25
NGM3220	M32x1.5	39	11	13-20
NGM4032	M40x1.5	48	13	22-32
NGM4026	M40x1.5	48	13	20-26
NGM4033	M40x1.5	48	13	23-33.5
NGM5038	M50x1.5	49	13	32-38
NGM5031	M50x1.5	49	13	25-31

Metal Cable Gland

Material: Nickel-Plated Brass

Working Temperature: -40°C to 100°C in static state, Instantaneous heat resistance up to 120°C

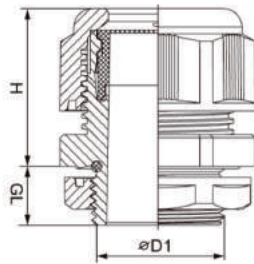

CAT#	Thread	Dimension (mm)		Cable Range
	φ D1	H	GL	mm
MGP0707	Pg7	19	5	3-6.5
MGP0705	PG7	19	5	2-5
MGP0908	PG9	21	6	4-8
MGP0906	PG9	21	6	2-6
MGP1110	PG11	22	6	5-10
MGP1107	PG11	22	6	3-7
MGP13512	PG13.5	23	6.5	6-12
MGP13509	PG13.5	23	6.5	5-9
MGP1614	PG16	24	6.5	10-14
MGP1612	PG16	24	6.5	7-12
MGP2118	PG21	25	7	13-18
MGP2116	PG21	25	7	9-16
MGP2925	PG29	31	8	18-25
MGP2920	PG29	31	8	13-20
MGP3632	PG36	37	8	22-32
MGP3626	PG36	37	8	20-26
MGP4238	PG42	38	9	32-38
MGP4231	PG42	38	9	25-31
MGP4844	PG48	49	10	37-44
MGP4835	PG48	49	10	29-35

CAT#	Thread	Dimension (mm)		Cable Range
	φ D1	H	GL	mm
MGM1207	M12x1.5	19	6.5	3-6.5
MGM1205	M12x1.5	21	6.5	2-5
MGM1608	M16x1.5	21	6	4-8
MGM1606	M16x1.5	22	6	2-6
MGM1610	M16x1.5	23	6	5-10
MGM2012	M20x1.5	23	6	6-12
MGM2009	M20x1.5	24	6	5-9
MGM2014	M20x1.5	25	6	10-14
MGM2518	M25x1.5	25	7	13-18
MGM2516	M25x1.5	31	7	9-16
MGM3225	M32x1.5	31	8	18-25
MGM3220	M32x1.5	37	8	13-20
MGM4032	M40x1.5	37	8	22-32
MGM4026	M40x1.5	37	8	20-26
MGM5038	M50x1.5	37	9	32-38
MGM5031	M50x1.5		9	25-31

Heat Shrinkable Tube



CAT#	Trade Size	Before Supplied		After Supplied		Wire Range mm
		I.D.(mm)	Thickness(mm)	I.D.(mm)	Thickness(mm)	
ST010	1.0mm	1.0±0.2	0.2±0.05	0.4±0.1	0.28±0.05	0.75-0.9
ST015	1.5mm	1.5±0.3	0.2±0.05	0.6±0.1	0.32±0.05	0.95-1.4
ST020	2.0mm	2.0±0.3	0.25±0.05	0.9±0.1	0.35±0.05	1.1-1.8
ST025	2.5mm	2.5±0.3	0.25±0.05	1.1±0.1	0.38±0.05	1.35-2.3
ST030	3.0mm	3.0±0.3	0.25±0.05	1.4±0.1	0.40±0.05	1.6-2.7
ST035	3.5mm	3.5±0.4	0.25±0.05	1.6±0.1	0.42±0.05	1.85-3.2
ST040	4.0mm	4.0±0.4	0.25±0.05	1.8±0.1	0.45±0.05	2.1-3.6
ST045	4.5mm	4.5±0.4	0.25±0.15	1.9±0.1	0.50±0.15	2.35-4
ST050	5.0mm	5.0±0.4	0.25±0.15	2.3±0.1	0.55±0.15	2.6-4.5
ST060	6.0mm	6.0±0.4	0.28±0.15	2.8±0.2	0.55±0.15	3.1-5.4
ST070	7.0mm	7.0±0.4	0.28±0.15	3.3±0.2	0.55±0.15	3.7-6.3
ST080	8.0mm	8.0±0.5	0.28±0.15	3.8±0.2	0.55±0.15	4.2-7.2
ST090	9.0mm	9.0±0.5	0.30±0.15	4.3±0.2	0.55±0.15	4.7-8
ST100	10mm	10±0.5	0.30±0.15	4.8±0.2	0.55±0.15	5.2-9
ST110	11mm	11±0.5	0.30±0.15	5.3±0.2	0.60±0.15	5.7-10
ST120	12mm	12±0.5	0.30±0.15	5.7±0.3	0.60±0.15	6.2-11
ST130	13mm	13±0.5	0.33±0.15	6.2±0.3	0.60±0.15	6.7-12
ST140	14mm	14±0.5	0.35±0.15	6.7±0.3	0.60±0.15	7.3-13
ST150	15mm	15±0.6	0.38±0.15	7.2±0.3	0.65±0.15	7.8-14
ST160	16mm	16±0.6	0.38±0.15	7.7±0.3	0.65±0.15	8.3-15
ST170	17mm	17±0.6	0.38±0.15	8.2±0.3	0.65±0.15	8.8-16
ST180	18mm	18±0.6	0.40±0.15	8.7±0.3	0.65±0.15	9.3-17
ST200	20mm	20±0.8	0.40±0.20	9.7±0.3	0.75±0.20	10.4-19
ST220	22mm	22±0.8	0.42±0.20	10±1.0	0.75±0.20	11.4-21
ST250	25mm	25±0.8	0.45±0.20	11±1.0	0.75±0.20	12.8-24
ST280	28mm	28±0.8	0.45±0.20	13±1.0	0.75±0.20	14.4-26
ST300	30mm	30±0.8	0.45±0.20	14±1.0	0.75±0.20	16-29
ST350	35mm	35±0.8	0.50±0.20	16±1.0	0.85±0.20	18-34
ST400	40mm	40±1.0	0.50±0.20	19±1.0	0.85±0.20	21-39
ST500	50mm	50±1.0	0.65±0.20	24±1.0	0.85±0.20	26-49

Ring Insulated Terminal

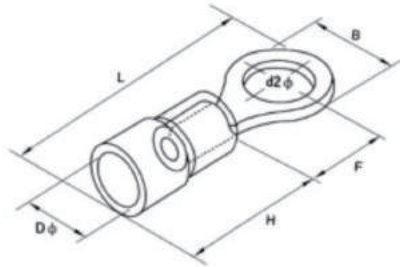

Cable Size: 0.5-1.5mm ² (AWG22-16)			Max Current: I _{MAX} =19A		Material: 0.75mm Copper				
CAT#	ITEM NO.	USA Screw	Screw Dia. d2(mm)	Dimension(mm)			H	Dφ	Color
				B	L	F			
HT001	RV1.25-3	#4	3.2	5.7	17.8	4.95	10	4.3	RED
HT002	RVS1.25-3.5	#6	3.7	5.7	17.8	4.95			
HT003	RVM1.25-3.5	#6	3.7	6.6	20.1	6.3			
HT004	RVL1.25-3.5	#6	3.7	8	21.5	7			
HT005	RVS1.25-4	#8	4.3	6.6	21.5	6.3			
HT006	RVL1.25-4	#8	4.3	8	20.1	7			
HT007	RVS1.25-5	#10	5.3	8	21.5	7			
HT008	RVL1.25-5	#10	5.3	9.8	24.5	8.5			
HT009	RVS1.25-6	1/4	6.5	9.8	23	8.5			
HT010	RVL1.25-6	1/4	6.5	11.6	23	11.1			
HT011	RV1.25-8	5/16	8.5	11.6	27.5	11.1			
HT012	RV1.25-10	3/8	10.5	13.6	31.6	13.9			
HT013	RV1.25-12	1/2	13	19.2	36	16.5			

Cable Size: 1.5-2.5mm ² (AWG16-14)			Max Current: I _{MAX} =27A		Material: 0.8mm Copper				
CAT#	ITEM NO.	USA Screw	Screw Dia. d2(mm)	Dimension(mm)			H	Dφ	Color
				B	L	F			
HT014	RV2-3	#4	3.2	6.6	17.8	4.3	10	4.9	BLUE
HT015	RVS2-3.5	#6	3.7	6.6	17.8	4.3			
HT016	RVM2-3.5	#6	3.7	6.6	21	7			
HT017	RVL2-3.5	#6	3.7	8.5	22.5	7.75			
HT018	RVS2-4	#8	4.3	6.6	21	6.5			
HT019	RVL2-4	#8	4.3	8.5	22.5	7			
HT020	RVS2-5	#10	4.3	8.5	22.5	7.75			
HT021	RVL2-5	#10	5.3	9.5	22.5	7.75			
HT022	RV2-6	1/4	6.5	12	27.6	11			
HT023	RV2-8	5/16	8.5	12	27.6	11			
HT024	RV2-10	3/8	10.5	13.6	30.2	13.9			
HT025	RV2-12	1/2	13	19.2	36.5	16.5			

Cable Size: 4-6mm ² (AWG12-10)			Max Current: I _{MAX} =48A		Material: 1.0mm Copper				
CAT#	ITEM NO.	USA Screw	Screw Dia. d2(mm)	Dimension(mm)			H	Dφ	Color
				B	L	F			
HT026	RV5.5-3.5	#6	3.7	7.2	21.4	5.9	13	6.7	YELLOW
HT027	RVS5.5-4	#8	4.3	7.2	21.4	5.9			
HT028	RVL5.5-4	#8	4.3	9.5	25.5	8.3			
HT029	RV5.5-5	#10	5.3	9.5	25.5	8.3			
HT030	RV5.5-6	1/4	6.5	12	31.5	13			
HT031	RV5.5-8	5/16	8.5	15	33.7	13.7			
HT032	RV5.5-10	3/8	10.5	15	33.7	13.7			
HT033	RV5.5-12	1/2	13	19.2	38.1	16			

Spade Insulated Terminal

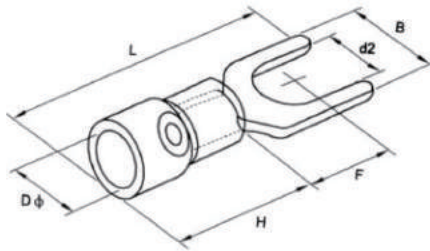

Cable Size: 0.5-1.5mm ² (AWG22-16)			Max Current: I _{MAX} =19A	Material: 0.75mm Copper						
CAT#	ITEM NO.	USA Screw	Screw Dia. d2(mm)	Dimension(mm)						Color
				B	L	F	H	Dφ		
HT101	SV1.25-3	#4	3.2	5.7	21.2	6.5	10	4.3	RED	
HT102	SVS1.25-3.5	#6	3.7	5.7	21.2	6.5				
HT103	SVL1.25-3.5	#6	3.7	6.4	21.2	6.5				
HT104	SVS1.25-4	#8	4.3	6.4	21.2	6.5				
HT105	SVM1.25-4	#8	4.3	7.2	21.2	6.5				
HT106	SVL1.25-4	#8	4.3	8.1	21.2	6.5				
HT107	SVS1.25-5	#10	5.3	8.1	21.2	6.5				
HT108	SVL1.25-5	#10	5.3	9.5	21.2	6.5				
HT109	SVS1.25-6	1/4	6.5	9.5	21.2	6.5				
HT110	SVL1.25-6	1/4	6.5	12.0	27.2	11.0				

Cable Size: 1.5-2.5mm ² (AWG16-14)			Max Current: I _{MAX} =27A	Material: 0.8mm Copper						
CAT#	ITEM NO.	USA Screw	Screw Dia. d2(mm)	Dimension(mm)						Color
				B	L	F	H	Dφ		
HT111	SV2-3	#4	3.2	5.7	21.2	6.5	10	4.9	BLUE	
HT112	SVS2-3.5	#6	3.7	5.7	21.2	6.5				
HT113	SVL2-3.5	#6	3.7	6.4	21.2	6.5				
HT114	SVS2-4	#8	4.3	6.4	21.2	6.5				
HT115	SVM2-4	#8	4.3	7.2	21.2	6.5				
HT116	SVL2-4	#8	4.3	8.1	21.2	6.5				
HT117	SVS2-5	#10	5.3	8.1	21.2	6.5				
HT118	SVL2-5	#10	5.3	9.5	21.2	6.5				
HT119	SVS2-6	1/4	6.5	9.5	21.2	6.5				
HT120	SVL2-6	1/4	6.5	12.0	27.2	11.0				

Cable Size: 1.5-2.5mm ² (AWG16-14)			Max Current: I _{MAX} =27A	Material: 0.8mm Copper						
CAT#	ITEM NO.	USA Screw	Screw Dia. d2(mm)	Dimension(mm)						Color
				B	L	F	H	Dφ		
HT121	SV5.5-3.5	#6	3.7	8.3	25.2	7.5	13	6.7	YELLOW	
HT122	SVS5.5-4	#8	4.3	8.3	25.2	7.5				
HT123	SVL5.5-4	#8	4.3	9.0	25.2	7.5				
HT124	SV5.5-5	#10	5.3	9.0	25.2	7.5				
HT125	SVS5.5-6	1/4	6.5	9.0	25.2	7.5				
HT126	SVL5.5-6	1/4	6.5	12.0	31.2	12.0				
HT127	SV5.5-8	5/16	8.5	14.0	30.0	11.5				

Crewel Tube Pre-Insulating Terminal

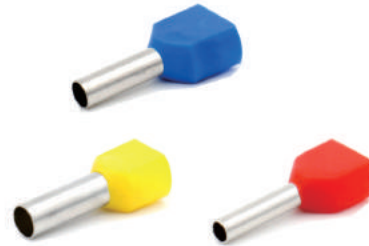
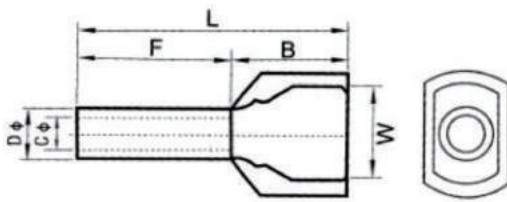

Max Voltate: 105°C Ui300V		Material: Copper	Insulating Material: Nylon					
CAT#	ITEM NO.	Wire Range (AWG/mm ²)	Dimension(mm)					
			F	L	W	B	Dφ	Dφ
HT201	TE0508	2x22 / 2x0.5	8	14.5	5	6.5	1.8	1.5
HT202	TE7508	2x20 / 2x0.75	8	14.5	5.5	6.7	2.1	1.8
HT203	TE7510	2x20 / 2x0.75	10	16.7				
HT204	TE1008	2x18 / 2x1.0	8	15.1	5.5	7.1	2.3	2
HT205	TE1010	2x18 / 2x1.0	10	17.1				
HT206	TE1508	2x16 / 2x1.5	8	15.5	6.4	7.2	2.6	2.3
HT207	TE1512	2x16 / 2x1.5	12	19.5				
HT208	TE2510	2x14 / 2x2.5	10	18.5	8	8.5	3.3	2.9
HT209	TE2513	2x14 / 2x2.5	13	21.5				
HT210	TE4012	2x12 / 2x4.0	12	23.1	8.8	11.1	4.2	3.8
HT211	TE6014	2x10 / 2x6.0	14	26.1	9.5	12.1	5.3	4.9
HT212	TE10-14	2x8 / 2x10.0	14	26.6	12.6	12.6	6.9	6.5
HT213	TE16-14	2x6 / 2x16.0	14	31.3	19	17.3	8.7	8.3



Insulated Core End Terminal

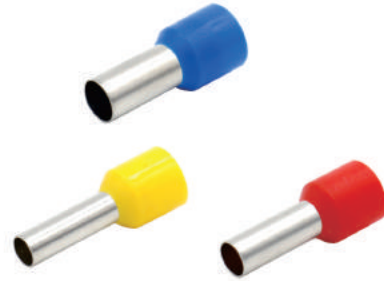
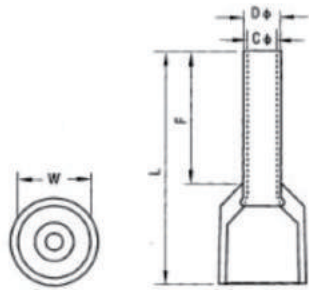

Max Voltate: 105°C Ui300V		Material: Copper		Insulating Material: Nylon			
CAT#	ITEM NO.	Wire Range (AWG/mm ²)	Dimemsiom(mm)				
			F	L	W	Dφ	Dφ
HT301	E0506	22 / 0.5	6	12	2.6	1.3	1
HT302	E0508		8	14			
HT303	E0510		10	16			
HT304	E0512		12	18			
HT305	E7506	20 / 0.75	6	12.4	2.8	1.5	1.2
HT306	E7508		8	14.6			
HT307	E7510		10	16.4			
HT308	E7512		12	18.4			
HT309	E1006	18 / 1.0	6	12.4	3	1.7	1.4
HT310	E1008		8	14.6			
HT311	E1010		10	16.4			
HT312	E1012		12	18.4			
HT313	E1508	18 / 1.0	8	14.6	3.5	2	1.7
HT314	E1510		10	16.4			
HT315	E1512		12	18.4			
HT316	E1518		18	24.4			
HT317	E2508	14 / 1.5	8	15.2	4	2.6	2.3
HT318	E2510		10	17.2			
HT319	E2512		12	19.2			
HT320	E2518		18	25.2			
HT321	E4009	12 / 4.0	9	16.5	4.4	3.2	2.8
HT322	E4012		12	19.5			
HT323	E4018		18	25.5			
HT324	E6010	10 / 6.0	10	18	6.3	3.9	3.5
HT325	E6012		12	20			
HT326	E6018		18	26			
HT327	E10-12	8 / 10.0	12	21.5	7.6	4.9	4.5
HT328	E10-18		18	27.5			
HT329	E16-12	6 / 16.0	12	22.2	8.8	6.2	5.8
HT330	E16-18		18	28.2			
HT331	E25-16	4 / 25.0	16	29	11.2	7.9	7.5
HT332	E25-22		22	35			
HT333	E35-16	2 / 35.0	16	30	12.7	8.7	8.3
HT334	E35-25		25	39			

Male Insulated Joint

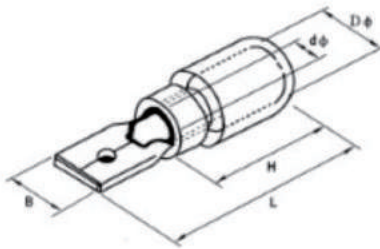

Cable Size: 0.5-1.5mm ² (AWG22-16) Max Current: I _{MAX} =10A Material: Copper									
CAT#	ITEM NO.	Name Tab (mm)	Thickness of Material(mm)	Dimension(mm)					Color
				B	dφ	Dφ	L	H	
HJ001	MDD 1.25-110(5)	0.25*2.8	0.5	2.8	1.7	4.3	17.7	10	RED
HJ002	MDD 1.25-110(8)	0.8*2.8	0.8	2.8	1.7	4.3	17.7		
HJ003	MDD 1.25-187(5)	0.5*4.75	0.5	4.75	1.7	4.3	20		
HJ004	MDD 1.25-187(8)	0.8*4.75	0.8	4.75	1.7	4.3	20		
HJ005	MDD 1.25-250	0.8*6.35	0.4*2	6.35	1.7	4.3	21		

Cable Size: 1.5-2.5mm ² (AWG16-14) Max Current: I _{MAX} =15A Material: Copper									
CAT#	ITEM NO.	Name Tab (mm)	Thickness of Material(mm)	Dimension(mm)					Color
				B	dφ	Dφ	L	H	
HJ006	MDD 2-187(5)	0.5*4.75	0.5	4.75	2.3	4.3	20	10	BLUE
HJ007	MDD 2-187(8)	0.8*4.75	0.8	4.75	2.3	4.3	20		
HJ008	MDD 2-250	0.8*6.35	0.4*2	6.35	2.3	4.3	21		

Cable Size: 4-6mm ² (AWG12-10) Max Current: I _{MAX} =24A Material: Copper									
CAT#	ITEM NO.	Name Tab (mm)	Thickness of Material(mm)	Dimension(mm)					Color
				B	dφ	Dφ	L	H	
HJ009	MDD 5.5-250	0.8*6.35	0.4*2	6.35	3.4	5.7	25	13	YELLOW

Female Insulated Joint

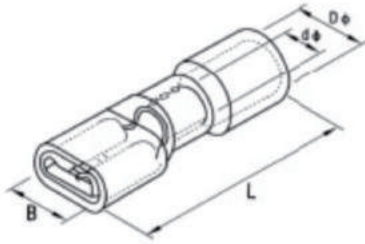

Cable Size: 0.5-1.5mm ² (AWG22-16)		Max Current: I _{MAX} =10A		Material: Copper					
CAT#	ITEM NO.	Name Tab (mm)	Thickness of Material(mm)	Dimension(mm)					Color
				B	dφ	Dφ	L	H	
HJ011	FDD 1.25-110(5)	0.5*2.8	0.3	3.8	1.7	3.8	19	10	RED
HJ012	FDD 1.25-110(8)	0.8*2.8	0.3	3.8	1.7	3.8	19		
HJ013	FDD 1.25-187(5)	0.8*4.75	0.35	5.6	1.7	3.8	19		
HJ014	FDD 1.25-187(8)	0.8*4.75	0.35	5.6	1.7	3.8	19		
HJ015	FDD 1.25-205	0.5*5.2	0.35	6.5	1.7	3.8	20		
HJ016	FDD 1.25-250	0.8*6.35	0.4	7.4	1.7	3.8	21		

Cable Size: 1.5-2.5mm ² (AWG16-14)		Max Current: I _{MAX} =15A		Material: Copper					
CAT#	ITEM NO.	Name Tab (mm)	Thickness of Material(mm)	Dimension(mm)					Color
				B	dφ	Dφ	L	H	
HJ017	FDD 2-110(5)	0.5*2.8	0.3	3.8	2.3	4.3	19	10	BLUE
HJ018	FDD 2-110(8)	0.8*2.8	0.3	3.8	2.3	4.3	19		
HJ019	FDD 2-187(5)	0.5*4.75	0.35	5.6	2.3	4.3	19		
HJ020	FDD 2-187(8)	0.8*4.75	0.35	5.6	2.3	4.3	19		
HJ021	FDD 2-205	0.5*5.2	0.35	6.5	2.3	4.3	20		
HJ022	FDD 2-250	0.8*6.35	0.4	7.4	2.3	4.3	21		
HJ023	FDD 2-312	0.8*8	0.4	9	2.3	4.3	23		

Cable Size: 4-6mm ² (AWG12-10)		Max Current: I _{MAX} =24A		Material: Copper					
CAT#	ITEM NO.	Name Tab (mm)	Thickness of Material(mm)	Dimension(mm)					Color
				B	dφ	Dφ	L	H	
HJ024	FDD 5.5-250	0.8*6.35	0.4	7.4	3.4	5.7	25	13	YELLOW
HJ025	FDD 5.5-375	1.2*9.4	0.5	10.9	3.4	5.7	29.6		

Twist-on Wire Connector

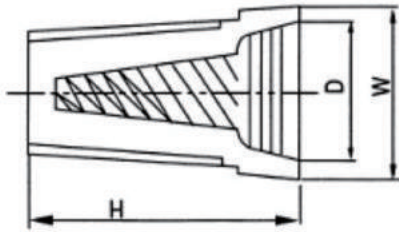

CAT#	Dimension(mm)			Wire Range		Color
	H	W	D	AWG	mm ²	
PG1	15	8.7	6.5	22-18	0.5-1.0	Grey
PB2	18	10	7.5	18-16	1.0-1.5	Blue
PO3	23	11.2	9.5	16-14	1.5-2.5	Orange
PY4	24.2	13.6	10.8	14-12	2.5-4	Yellow
PR6	27.8	16.1	12.7	12-10	4-6	Red

Close-end Wiring Connector

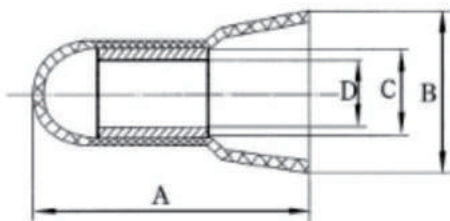

CAT#	Dimension(mm)				Wire Range	
	A	B	C	D	AWG	mm ²
CF3	17.8	7.2	5.5	2.5	22-16	1.25
CF4	21	8.2	5.8	2.9	16-14	2
CF5	22.5	9	6.7	3.9	12-10	5.5
CF6	25	10	7.8	4.5	8	8
CF7	24.2	11	9.4	5.4	8-6	10
CF8	25.6	11.8	10.2	6	6	13

Spiral Wrapping Bands

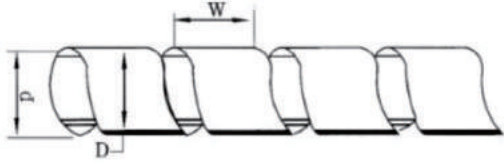

CAT#	I.D. (mm)	O.D. (mm)	Pitch (mm)	Wrapping Range	Packing
	d	D	W	(mm)	M/Roll
SWB-6	4	6	7	4-50	10
SWB-8	6	8	10.8	6-60	
SWB-10	7.5	10	11.4	7.5-60	
SWB-12	9	12	13.9	9-65	
SWB-15	12	15	15	12-75	
SWB-19	15	19	18.2	15-100	
SWB-24	20	24	19.6	20-130	

R Type Cable Clamp

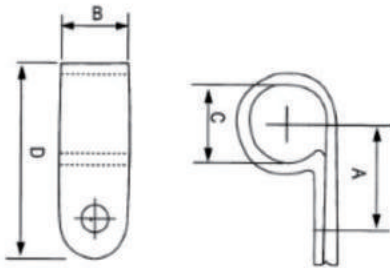

CAT#	Trade Size	Dimension (mm)			
		A	B	C	D
R0108	1/8"	9.5	9.6	3.2	19.8
R0316	3/16"	9.6	9.6	4.8	19.8
R0104	1/4"	12	10	6.38	22
R0516	5/16"	12	10	7.9	22
R0308	3/8"	12.5	12	9.5	24
R0102	1/2"	15.2	12	12.7	31
R0508	5/8"	18.2	12	15.8	34
R0304	3/4"	18.2	12	19.4	35
R1010	1"	22	12	25.4	43

Round Nail Cable Clip

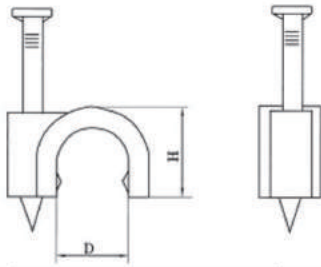

CAT#	Trade Size	Dimension (mm)		
		D	H	Nail
NC04	4mm	4	5.3	1.7*15
NC05	5mm	5	6.5	1.7*15
NC06	6mm	6	8.1	1.7*17
NC07	7mm	7	8.7	1.8*20
NC08	8mm	8	9.6	1.9*20
NC09	9mm	9	10.7	2.0*22
NC10	10mm	10	11.7	2.0*25
NC12	12mm	12	12.8	2.3*25
NC14	14mm	14	14.9	2.4*32
NC16	16mm	16	16.9	2.5*35
NC18	18mm	18	20.8	2.5*37
NC20	20mm	20	23.6	2.8*40
NC22	22mm	22	25	2.8*42
NC25	25mm	25	27.7	3.0*48
NC30	30mm	30	33.1	3.2*53
NC35	35mm	35	36.6	3.5*58
NC40	40mm	40	45.2	3.5*68

Square Nail Cable Clip

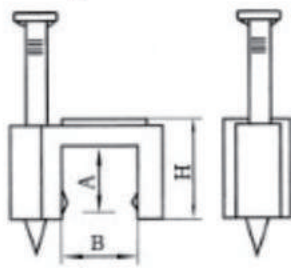

CAT#	Trade Size	Dimension (mm)			Nail
		A	B	H	
NS04	4mm	3.8	4	6	1.7*15
NS05	5mm	3.8	5	6	
NS06	6mm	4.1	6	6.5	
NS07	7mm	4.7	7	7	1.8*20
NS08	8mm	5	8	7.5	
NS09	9mm	5.4	9	8.2	
NS10	10mm	5.7	10	8.6	2.0*22
NS12	12mm	6.1	12	9	
NS14	14mm	6.5	14	11.2	
NS16	16mm	8.4	16	11.6	2.3*25

H Type Nylon Terminal Block



CAT#	Rated Current	Wire Section
	(Amp)	(mm ²)
H003	3	4
H006	6	6
H010	10	10
H015	15	12
H020	20	14
H030	30	16
H060	60	25
H080	80	30
H100	100	35
H150	150	40

Nylon Cable Tie Mounts



CAT#	Rated Current
	(Amp)
TM20	20x20
TM25	25x25
TM30	30x30
TM40	40x40

PVC Cable Markers



CAT#	Wire Section
	(mm ²)
EC0	0.75-1.5
EC1	0.75-3.5
EC2	3.5-8
EC3	5.2-10

SM Bus Bar Insulator

Material: BMC/SMC with Brass Insert

Operating Temperature: -40°C to 140°C

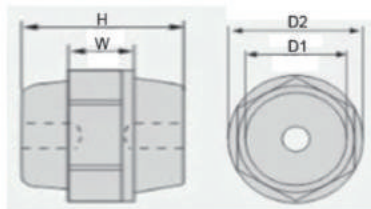

CAT#	Dimension(mm)				Tensile Strength LBS	Voltage Withstand KV	Torgue Strength FT LBS	Screw mm	Screw Depth mm
	W	H	D1	D2					
SM20	5	20	15	17	300	5	4	5	7
SM25S	6	25	15	19	400	6	5	6	8
SM25	10	25	23	30	500	6	6	6	9
SM30	10	30	27	32	550	8	8	8	11
SM35	10	35	28	32	600	10	10	8	11
SM40	10	40	33	40	650	12	12	8	11
SM45	10	45	30	36	1000	14	20	8	11
SM51	12	51	29	36	1000	15	20	8	14
SM60	13	60	34	46	1200	20	35	10	15
SM76	15.5	76	35	50	1500	25	40	10	20

SC Terminal Cable Lug

SC Terminales



Material: High Electrolytic Grade Copper with Tin Plated
 Application: Ideal for Marine, Automotive or Outdoor Applications.
 Meet Relevant European Standards

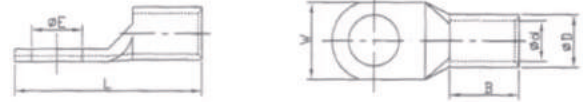

CAT#	Trade Size	Dimension (mm)					
		ØE	ØD	Ød	W	B	L
HSC1540	1.5mm ²	4.2	3.6	1.8	8.0	5	16
HSC1550	1.5mm ²	5.2	3.6	1.8	10.0	5	17
HSC1560	1.5mm ²	6.5	3.6	1.8	10.0	5	18
HSC2540	2.5mm ²	4.2	3.9	2.4	8.0	7	18
HSC2550	2.5mm ²	5.2	3.9	2.4	10.0	7	20
HSC2560	2.5mm ²	6.5	3.9	2.4	10.0	7	20
HSC4040	4mm ²	4.2	4.7	2.4	10.0	7	20
HSC4050	4mm ²	5.2	4.7	3.1	10.0	7	20
HSC4060	4mm ²	6.5	4.7	3.1	10.0	7	20
HSC4080	4mm ²	8.4	4.7	3.1	12.5	7	23
HSC6040	6mm ²	4.2	5.4	3.8	10.0	9	24
HSC6050	6mm ²	5.2	5.4	3.8	10.0	9	24
HSC6060	6mm ²	6.5	5.4	3.8	12.0	9	24
HSC6080	6mm ²	8.4	5.4	3.8	12.5	9	26
HSC6010	6mm ²	10.5	6.0	4.0	15.0	9	28
HSC1050	10mm ²	5.2	6.1	4.5	12.0	9	25
HSC1060	10mm ²	6.5	6.1	4.5	12.0	9	25
HSC1080	10mm ²	8.4	6.1	4.5	12.5	9	27
HSC1010	10mm ²	10.5	6.1	4.5	15.0	9	29

1.5mm²-1000mm² is available

Authorized distributor



汉纳森电气
HANYSEN
PERFECT ELECTRICAL SOLUTION

Tel/Fax:+86 571 82675286

Cell/Wechat:+86 18058129110

Rm1405, Office Building B, Henglong Square,
Xiaoshan District, Hangzhou, Zhejiang, China

info@hanysen.net benson@hanysen.net